

NOTES

GENERAL

These drawings shall be read in conjunction with architectural, structural and other related drawings and specifications.

SERVICES:

Before landscaping work commences, the contractor shall establish the position of all service lines and ensure tree planting takes place at least 2 metres away.

CONTAMINATED SOIL:

Remove all soil contaminated with petroleum products (petrol, oils, grease), construction waste (cement, lime, paint, brickbats, etc.) or any other contaminant likely to impede proper plant growth.

Replace with clean, weed free topsoil and prepare according to garden bed details and specification.

TREES TO BE PROTECTED:

Ensure trees to be retained are adequately protected during construction. Install protective fencing and/or trunk armouring as necessary, to all trees, sufficient to protect trunk, rootball and canopy, prior to commencement of site works.

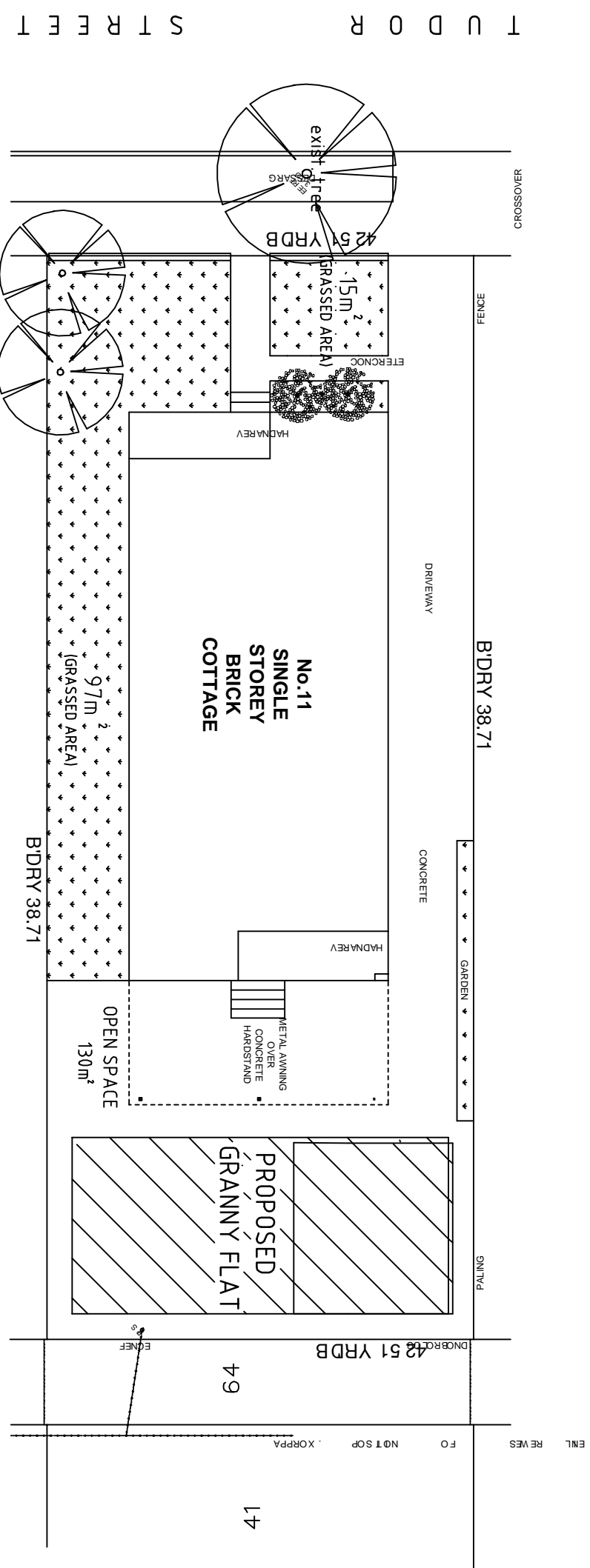

SITE PLAN 1:200

LANDSCAPING NOTES

- SITE AREA = 590m²
- BUILDING AREA = 270m²(including verandahs)
- HARD SURFACE AREA = 190m²
- SOFT LANDSCAPE AREA = 123m²
- SOFT LANDSCAPE AREA = 21%

Existing trees & Shrubs

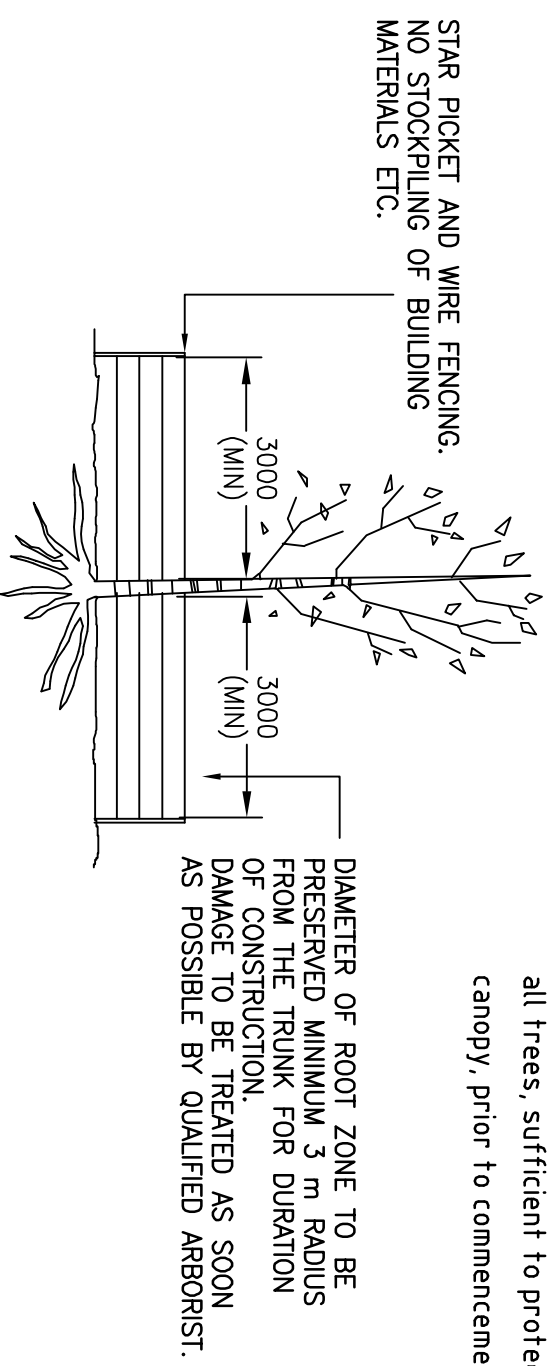

DETAIL – PROTECTION OF EXISTING TREES

Job					
PROPOSED GRANNY FLAT AT No.11 TUDOR ST BELMORE.		JAY DESIGN ARCHITECTURAL & PROJECT MANAGEMENT 235 BURWOOD RD BELMORE, 2192 TEL/FAX: 9703 0975, M: 0419 618 817 EMAIL: jonjay14@optusnet.com.au			
Scale	1:200 @ A3	Client	MR & MRS SAOUMA	Drawings	Dwg. No.
Date	APRIL 2023	Amendments		LANDSCAPE PLAN	1
		Drawn By	JOHN GEORGIOU		1
			0419 618 817		23-08